

Dry Scroll Vacuum Pump

ISP series Air-cooled

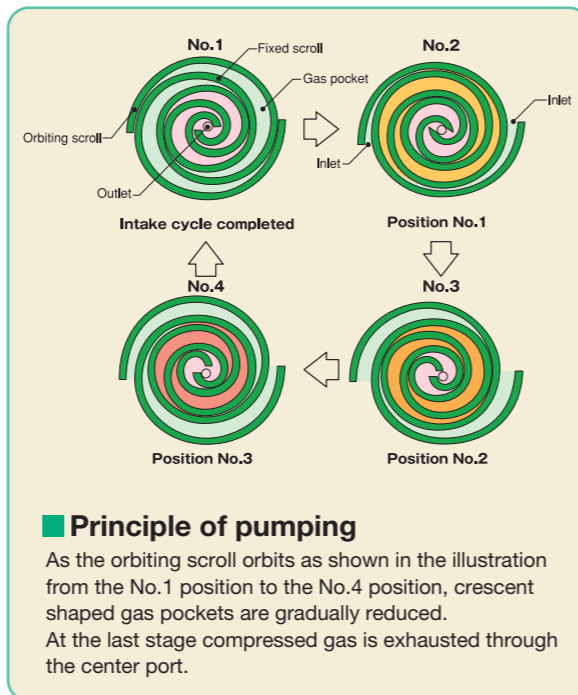

LR104996
Our product have got
CSA approval (Canadian
Standards Association)

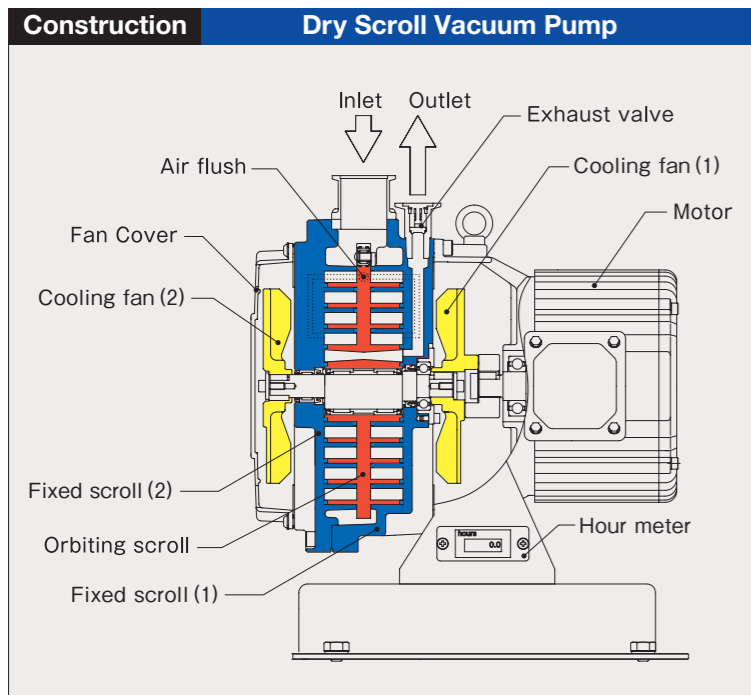

⚠️ Precaution on Usage

- This vacuum pump is designed for use on **Clean processes only**.
- Do not use explosive, flammable, toxic or corrosive substances or substances which contain chemicals, solvents or particles. ANEST IWATA will not perform maintenance work on pumps which have used hazardous substances.
- Do not disassemble, reassemble or alter pump and parts on user's side.
- Be sure to read operating instruction manual and understand it fully before use.
- When maintenance interval becomes due, be sure to contact your distributor.
- The warranty terms and conditions are on instruction manual. Maintenance interval and the warranty terms and conditions are period are different.
- Please contact Vacuum Pump Dept. of ANEST IWATA Corporation before exporting pumps which are shown on this catalog to out side of Japan.

⚠️ Precaution on installation

- Danger of explosion and fire**
- Install in an area which is not exposed to explosives, flammable gas, or other hazardous environment.
 - Pumps which are shown in this catalog do not have a circuit breaker for protecting motor from burnout. Install a circuit breaker to protect motor from burnout.
 - Electric power cable is not included. Use electric power cable which is complied with local electric regulator.
 - This vacuum pump is required periodic maintenance at interval which is shown on the instruction manual.
 - Install the pump where sufficient ventilation and an open area for maintenance procedures are available.

Try to Dry

● Models, specifications and photos are subject to change without notice.

■ More Information

ANEST IWATA Corporation

3176, Shinyoshida-cho, Kohoku-ku,
Yokohama 223-8501 Japan
Telephone: (81) 45-591-1112 Facsimile: (81) 45-593-1539
<http://www.anest-iwata.co.jp/>
E-Mail : ispinfo@anest-iwata.co.jp

ANEST IWATA Search

CAT.No.AP-V-5 2010.8.増2.0K★47.5



anest-iwata.co.jp

ANEST IWATA

OILFREE SCROLL VACUUM PUMP



ISP-50



Dimensions

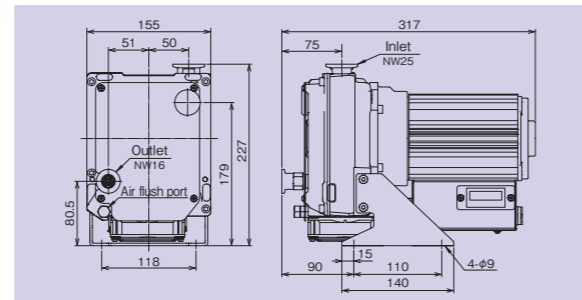

ISP-90



Dimensions

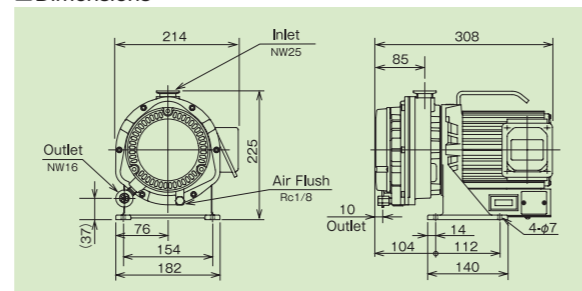

ISP-250c



Dimensions

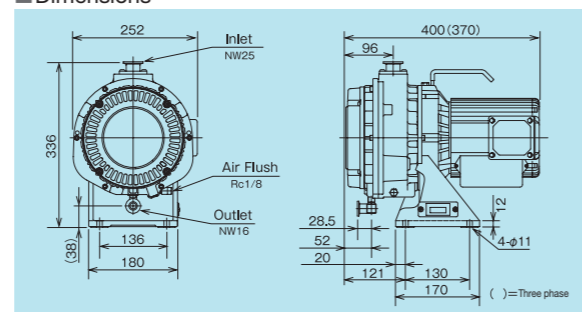

ISP-500c



Dimensions

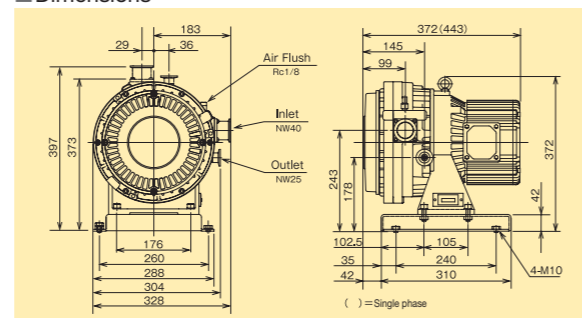

ISP-1000



Dimensions

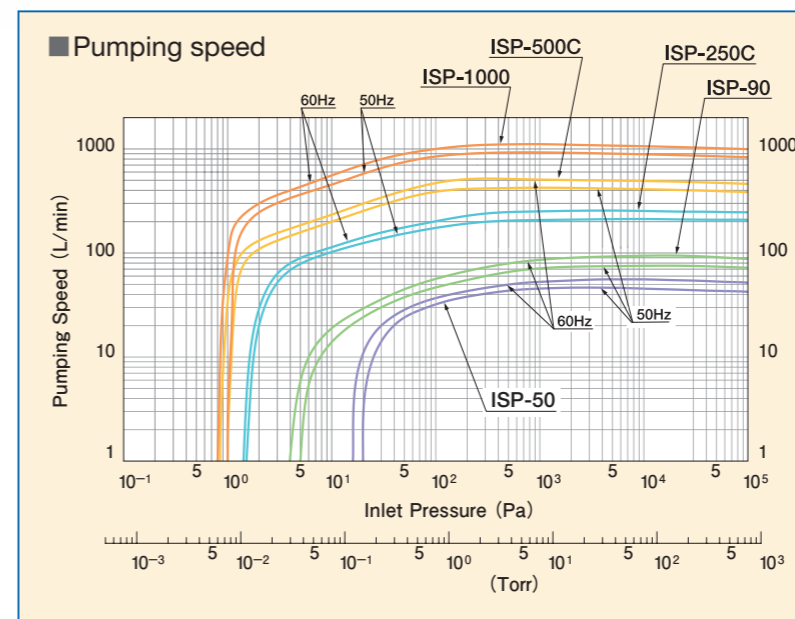
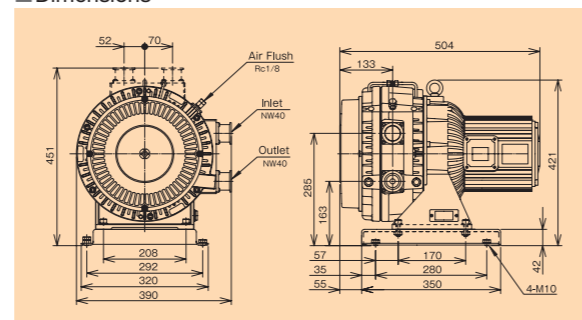

Air Flush
Purpose of Air Flush Pumping of humid gas by vacuum pump can cause condensed moisture to remain in pump. This remaining moisture can cause failure to ultimate pressure or pump. Air Flush operation is necessary to remove remaining moisture inside. Air Flush operation also recovers ultimate pressure.

How to select
ISP-500C-T-V
500= Pumping Speed of vacuum pump
T= Three phase
V= Vertical Inlet
S= Single phase
H= Horizontal Inlet

The model name of ISP-1000 is ISP-1000-TVA/THA, ISP-50 is change to ISP-50-SV1; single phase 100V, ISP-50-SV2; single phase 200V

Trade name		Oil free scroll vacuum pump				
Model		ISP-50	ISP-90	ISP-250C	ISP-500C	ISP-1000
Pumping Speed	L/min 50/60Hz	50/60	90/108	250/300	500/600	1000/1200
Ultimate pressure	Pa 50/60Hz	≤20/15	≤5	≤1.6	≤1	
Motor power	kW	0.1	0.15	0.4	0.6	1.4
Voltage	V	AC100V (50/60Hz), 115V (60Hz) (with thermal protector) AC200V, 230V (50/60Hz) (with thermal protector)				—
		100, 115, 200, 230 (with thermal protector)				—
Noise level	dB (A)	48(at air flush57)	52(at air flush57)	58(at air flush66)	60(at air flush68)	67(at air flush74)
Weight	kg	12	14	25	44	—
		—	—	23	38	56
Leak tightness	Pa·m³/s	≤1×10 ⁻⁷		≤1×10 ⁻⁵		
Water Vapor Capacity	g/day	3(at air flush)	5(at air flush)	25(at air flush)		
Air flush	L/min	4	9	10		
Inlet connection	NW	25			40	
Outlet connection	NW	16	25	40		
Cooling system		air-cooled				
Ambient temperature	°C	5~40				10~40

● Ultimate pressure is measured as total pressure. Noise is measured in an anechoic room.

Applications

- Sputtering equipment, Vacuum deposition equipment, Ion plating equipment
- Gas recovery devices
- Vacuum equipment
- Leak detectors
- Device handling system

Synchrotron Facility

Evacuation units for beamlines in Synchrotron and Accelerator Facilities

High Vacuum Pumping System

Roughing pump for Turbo Molecular Pump and Mechanical Booster Pump

- Surface modification, Electron beam process
- Vacuum furnace, Heat treatment furnace
- Laboratory use
- Vacuum packaging machine
- Others